



Aquiles Softbench

Technical data sheet



Technical data

Basic product types and dimensions

Dimensions may slightly differ, depending on thematic modifications

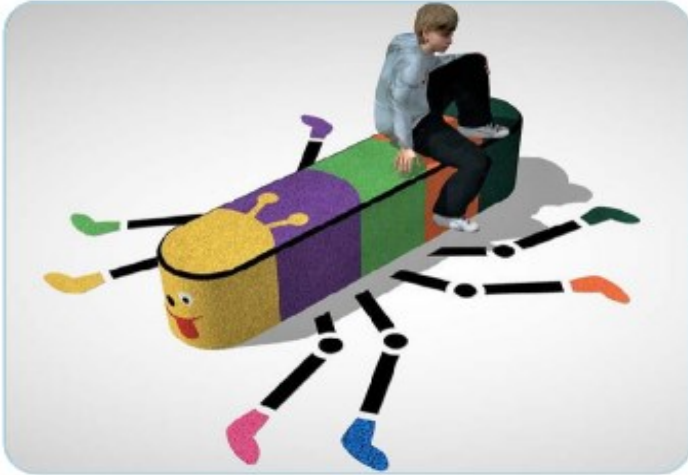

1 – PLAY - DIRECT Bench

Dimensions: L x H x W (2,200mm x 500mm x 500mm)

Weight: 200Kg +/- 20kg

2 – PLAY - BOW Bench

Dimensions: L x H x W (2,100mm x 500mm x 500mm)

Weight: 200Kg +/- 20kg



3 – PLAY - PROMO Bench

Dimensions: L x H x W (2,200mm x 500mm x 500mm)

Weight: 200kg +/- 20kg

Impact surface size

1. Separate placement

There should be no obstacles within a radius of 1,5 m from the base of the Aquiles Softbench

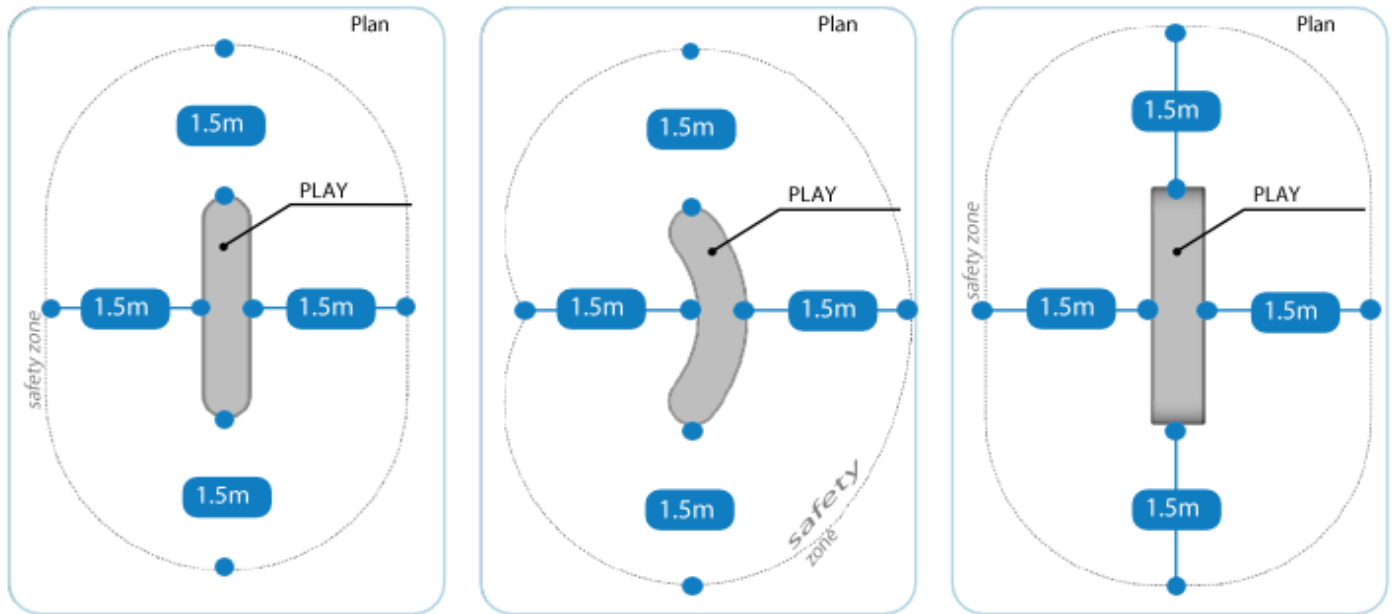

2. Cluster arrangement

Two or more benches, palissades and demispheres arranged next to each other in a group so as to maintain continuity, which is necessary for playing activities, such as obstacle trail. There should be no obstacles within a radius of 1,5 m from the base of the Aquiles Softbench.

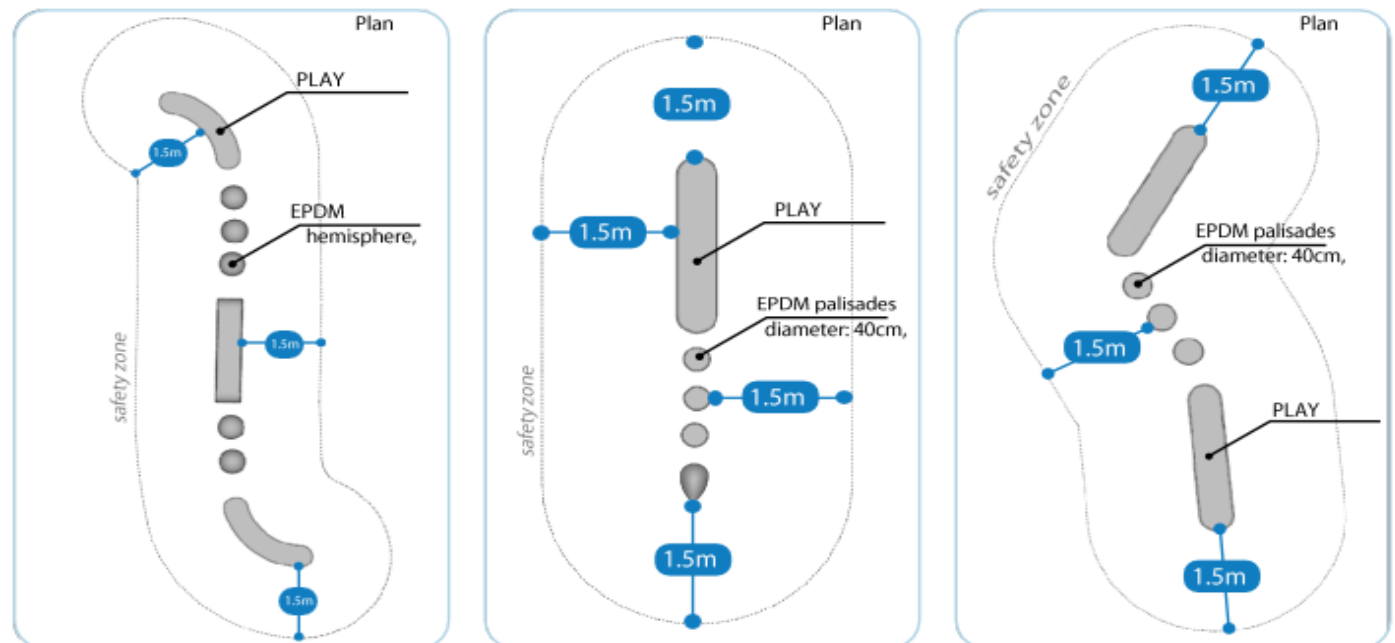

Critical fall height

Because the bench does not exceed the free fall height of 600 mm, this equipment doesn't require any certified impact surface

Installation and assembly

The Aquiles Softbench is designed to be installed directly on EPDM surfaces of playgrounds, sportground and playrooms. However, it can also be installed on other surface types. It must be installed on solid and stable base, see sectional views below.

Possible surrounding surfaces for Aquiles Softbench installation:

- EPDM surfaces: to be glued to an SBR layer, see instructions below
- SBR & EPDM rubber mulch: to be glued to an SBR layer or concrete base
- Artificial grass: to be installed on a concrete base
- Pavement, concrete, tarmac: to be glued or to be placed freely
- Loose material (pebble gravel, chips, sand,...): to be installed on a concrete base

1. Gluing to the first EPDM surface layer

To be glued onto an SBR layer; an EPDM layer is to be applied subsequently

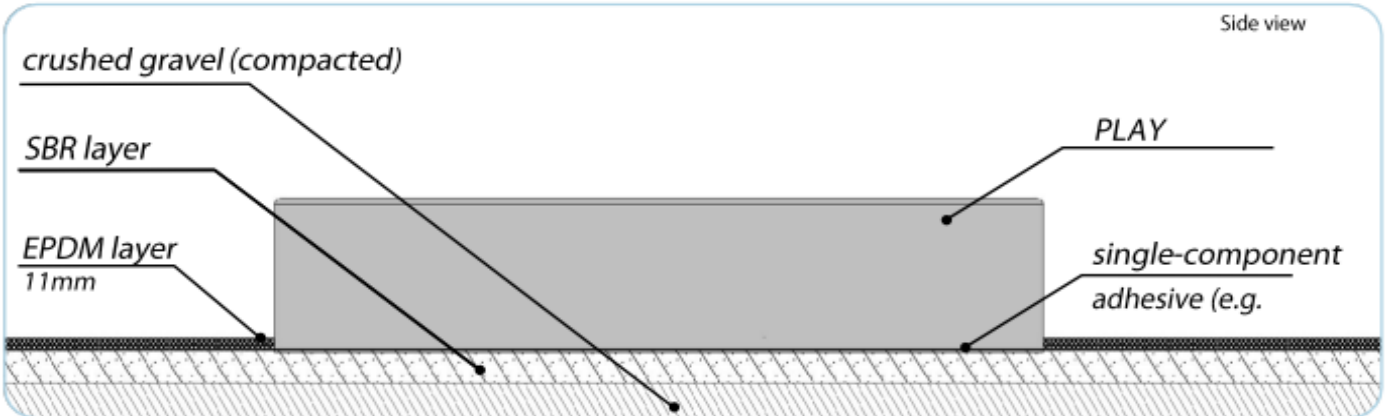

2. Gluing to a solid base

This includes concrete, pavement, tarmac, etc.

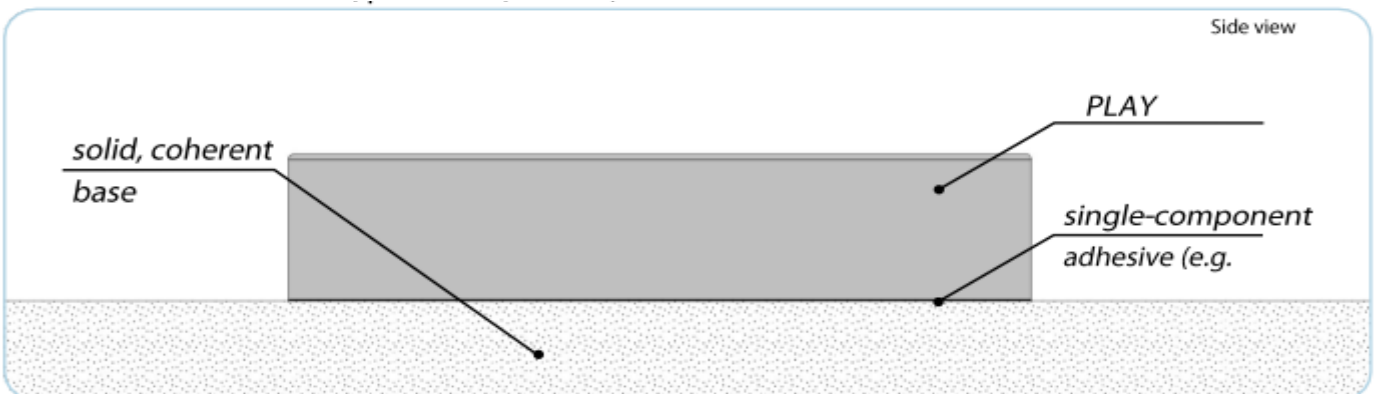

3. Gluing in places with loose material surface (e.g. pebble gravel)

We recommend always installing the bench horizontally (+/- 1%) on a level and solid surface.

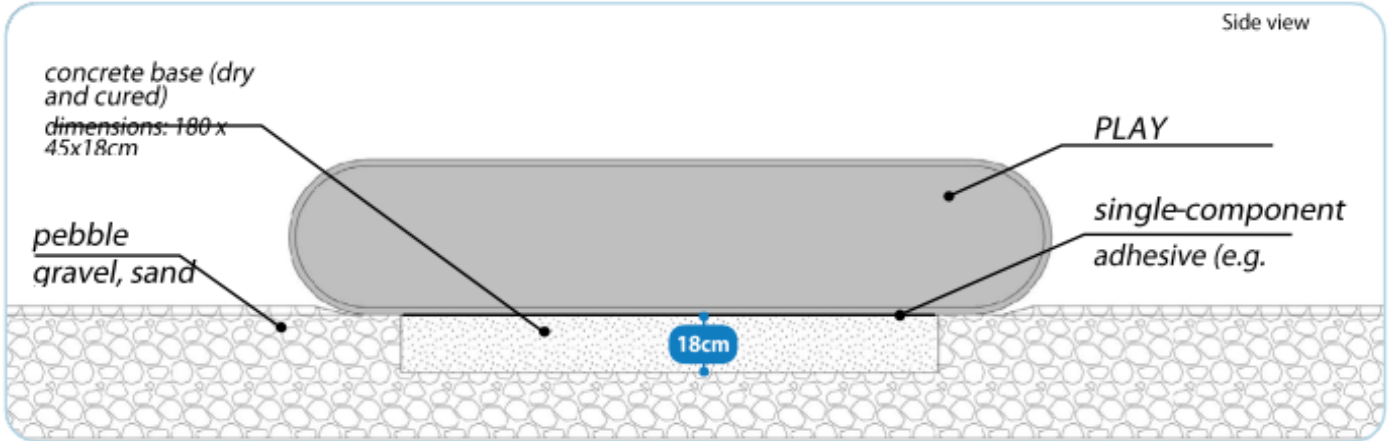

The bench must not be installed on loose, incoherent or uneven surface!

Transport and storage

The Aquiles Softbench is packaged in PVC foil and placed onto wooden pallets for easier handling. The bench is installed onto a pre-prepared base on-site (straps are used for carrying) For more information, please see the installation instructions on the next page.



Installation instructions

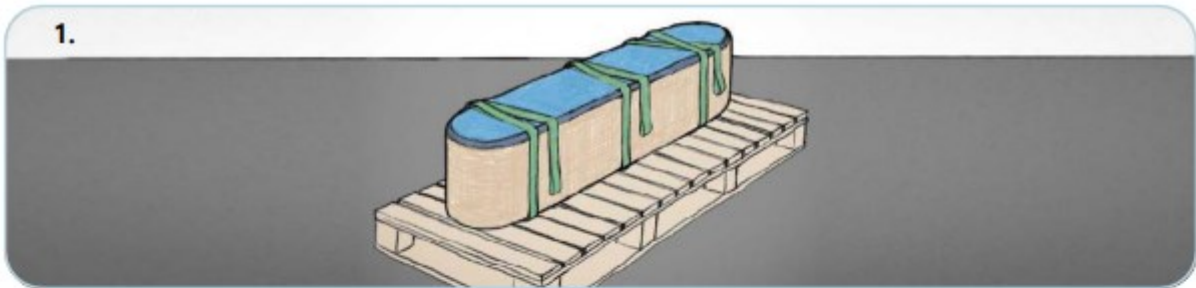

Unpack the bench, which is placed on a pallet with prepared carrying straps.

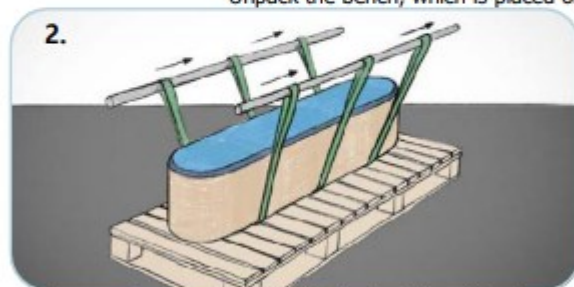

Prepare two steel rods of suitable length and insert them into the loops in the carrying straps.



Carry the bench using the rods as handles. Four people are necessary.

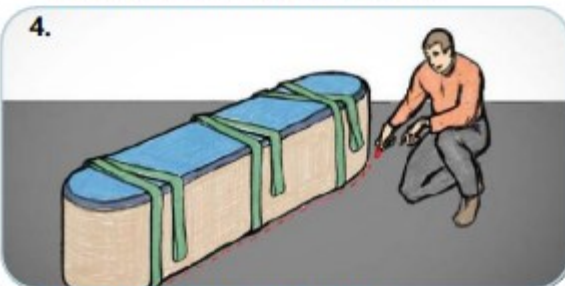

Trace the shape of the bench and then put it aside.



Apply the adhesive evenly on the installation place (SBR, concrete or tarmac).

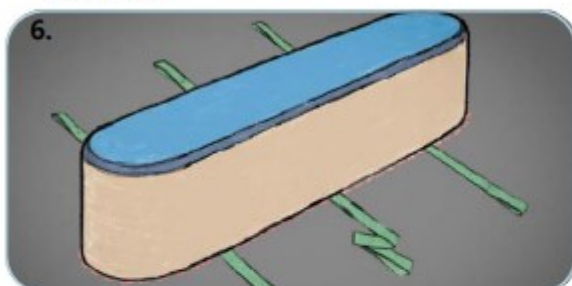

Put the bench back on the installation place.



Cut off the carrying straps as close to the bench as possible.



Apply primer around the base of the bench where it will be followed by the surrounding EPDM surface.



Now the installation is completed.



EPDM AQUILES SOFTBENCH

Safety, inspections and maintenance

Inspection of technical condition:

The Aquiles Softbench does not require any specific procedures to ensure its safe operation. The appropriate technical condition and frequency of inspections must be observed in compliance with EN 1176-7:2020, paragraph 6.

Routine visual inspection (once in a months):

Checking for obvious sources of risks caused by vandalism, use or weather conditions, such as damage to the outer EPDM layer. As part of a routine inspection it is also suitable to focus on the cleanness of the Aquiles Softbench surroundings.

Operation inspection (once in two months):

More detailed inspection checking the function and stability of the Aquiles Softbench, especially in terms of wear and integrity.

Main annual inspection (once a year):

Checking the general safety level of the Aquiles Softbench, base and surfaces.

Maintenance:

- Clean as necessary, e.g. sweeping, washing with water, or using a blower
- If the Aquiles Softbench is covered with dust, pollen or mud, clean it with pressurised water
- Impurities fallen onto the bench must be removed regularly so as to prevent moss and weeds from growing
- The surface must be kept free from any gross impurities (soil, gravel) that could damage it
- Remove sprinklings of snow by sweeping. If snow is shovelled, proceed with care in order not to damage the surface

The operator's other duties are based on the EN1176 and EN1177

Warranty

The warranty period for the Aquiles Softbench is 36 months

Certificates and tests

It complies with requirements for:

- Child health and safety
- Playing: according to EN1177:2018, EN1176-1 ed.2:2018 (under providal process)
- Amount of volatile substances: confirmed by the National Institute of Public Health
- Migration of heavy metals: according EN71-3:2019
- Absence of polycyclic aromatic hydrocarbons in surface
- Absence of phthalates: REACH test
- Non flammability: EN ISO 9239-1 tests, classification under EN 13501-1+A1
- Water infiltration rate: under EN 12616
- Resistance to abrasive wear: BS 7188:1998 + A2:2009, slip
- Resistance in both we and dry conditions: BS 7188:1998 + A2:2009
- Resistance to indentation: BS 7188:1998 + A2:2009